



The new battery-powered, remote control, E-Furler from LOOP® Products – designed to make life simpler and more enjoyable.

Why not furl your Code zero or gennaker comfortably and safely from the cockpit? Specifically designed for small boats up to 28 feet (sail areas up to 45 m²), the LOOP® EF1500 is a “must have” for the new season, for all sport boats and small multihulls!

The E-Furler is equipped with a powerful, re-chargeable 18 V lithium battery. With a press of the button, the drum lock is over-ridden to allow the sail to unfurl manually. When rolling up, simply press the button on the remote control and in a few seconds your sail will be rolled safely away.

- Plug & Play - Simple to install into most standard gennaker poles
- No wires or furling lines



Technical Data	
Charging time	1 Hour
Battery type	Li-Ion 18V, 3.0 Ah
Max. Torque	120 nm
Revolutions per minute	250 rpm
Break Load	1500 kg
Working Load	750 kg
Drum weight	2800 gr



The jaw self-aligns to the required luff angle, with 25 degrees of movement in all directions.



The Furler will be delivered with the remote control, cable, battery and charging station.



The furler jaw is a swivelling universal joint made from stainless steel and Torlon ball bearings.



To install: remove the pole end and slide the cable and the furler unit into the pole.

Loop Products is a well-respected manufacturer of innovative, modern deck hardware solutions.

The remote controlled, Loop E-Furler was specifically designed for short-handed furling of gennakers and code zeros on small boats under 30 ft to improve safety, comfort and ease of use.

Manufactured in Germany from high quality materials, It is robust, fully waterproof and designed for quick, simple, Plug & Play installation.

The choice of high power, 18V rechargeable lithium-ion batteries allows the E-Furler to be fully independent from other boat systems. With a single charge and under normal use the furler will be good for a weekend cruise.

However, with easy access to the battery compartment, a spare battery and just 1hr re-charging time, the Loop E-furler can be in constant use.

The furler body is made from Hard anodised aluminium. The furler jaw is a swivelling universal joint made from stainless

steel and Torlon ball bearings. The jaw self-aligns to the required luff angle, with 25 degrees of movement in all directions. And the drum is automatically locked when not in operation. The Loop E-Furler is designed to fit all standard, commercially available tube sizes used in small boat bowsprits.

It can be installed in fixed or deck-mounted, adjustable poles. To install: remove the pole end and slide the cable and the furler unit into the pole. Adapter kits are provided with the E-Furler for larger pole diameters to ensure a secure fit.

For a deck mounted pole the cable is connected to the battery pack which then fits into the aft end of the pole. In a fixed or adjustable below deck bowsprit the cable can exit the back of the pole and the battery pack mounted on the hull or bulkhead.

The Loop E-furler has a Safe working load of 1.5 t and the drum weighs 2.8 kg. It can deliver 120 nm of torque and 250 revolutions per minute

E-Furler

Dimensions	mm
A	466.24
B	130.5
C	335.74
D	63
E	79
F	100
G	92.1

Dimensions	mm
H	137.08
I	15
J	44,68
K	31,18
L	10,68
M	25
N	Ø 8

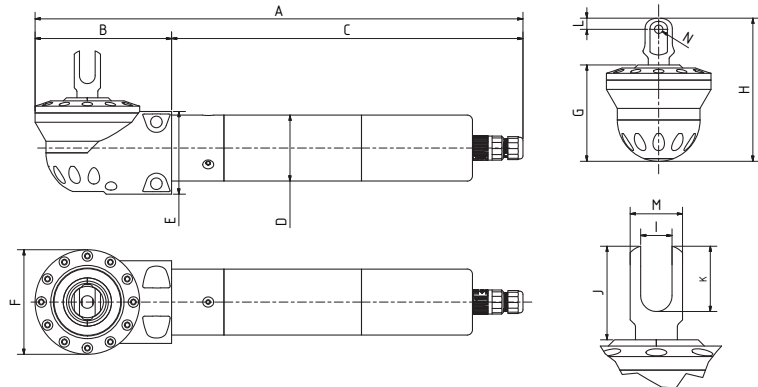

Battery-Housing

Dimensions	mm
A	202.24
B	150
C	52.24
D	65
E	23.42
F	57.5
G	49

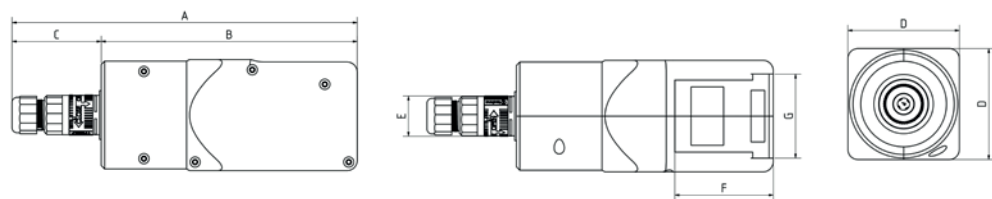

Battery Dimensions

Dimensions	mm
A	120
B	68
C	60
D	9.5
E	69.5
F	78
G	48

